

Remote Control Operation Guide

Model No. **EUR7722X80**

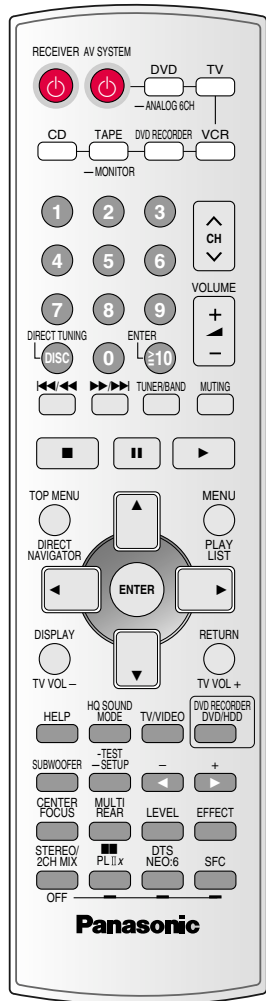

Welcome to the world of Home Theater.

This remote control is the key to your home theater experience.

RECEIVER



First, turn on the receiver.



Now, operate your other Home Theater components.

You may need to enter a code to operate some equipment.

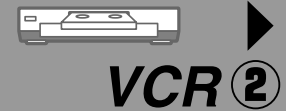

Actual operations depend on your equipment and software.
Be sure to read the instructions for the receiver and your other components.

1 DVD PLAYER/DVD RECORDER

Watching DVDs

Switch on

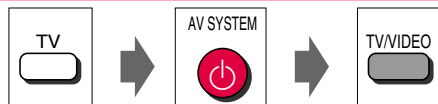

Switch on the television and select input

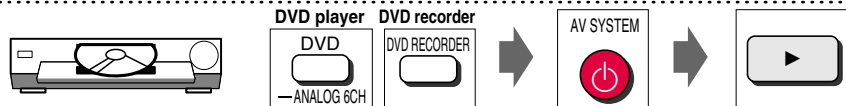

Switch on the player or recorder and start play

Switch off

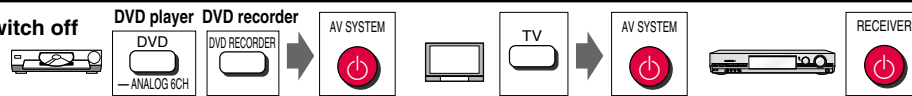

Operating the DVD player/DVD recorder

TOP MENU
DIRECT NAVIGATOR

MENU
PLAY LIST

DISPLAY
TV VOL -

Show disc menus

Show disc menus

Show player menus

Select and enter menu items



Start play from a selected item

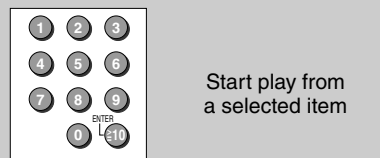

Skip items during play

Pause play

MENU

RETURN
TV VOL +

Clear the menus or return to the previous menu

SEARCH

(Press and hold)
Search through the disc

STOP

Stop play

DVD player only (5-disc changer)

DIRECT TUNING
DISC

Specify a disc

PAUSE

To view frame-by-frame

Operating the DVD recorder



Switch to the disc or hard disk drive

- When you cannot switch to the disc or hard disk drive, after performing the following operations, press this button again.

- Press [DVD RECORDER].
- While pressing [ENTER], press and hold [8] or [9] for approximately 2 seconds.

The factory setting is [9].

When using a Panasonic DVD recorder

Change the unit's remote control code to match the remote control code of the DVD recorder.

Preparations: Check the remote control code of the DVD recorder.

For about one second hold down both [ENTER] and the button ([1], [2] or [3]) which the same number as the remote control code set by the DVD recorder.

The factory setting is [1].

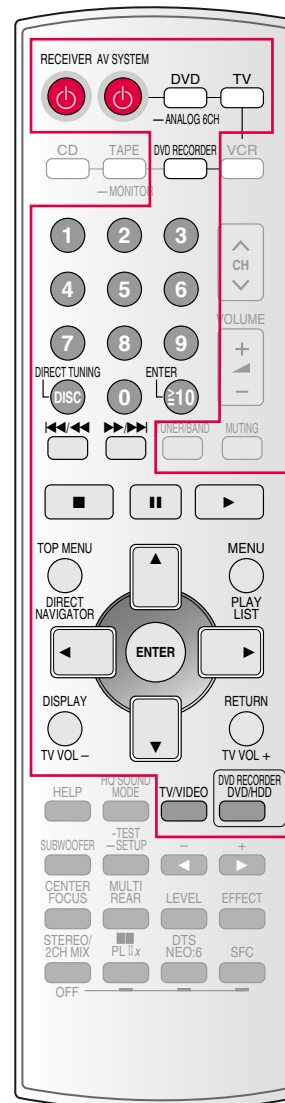

② VCR

Watching videotapes

Switch on



Switch on the television and select input

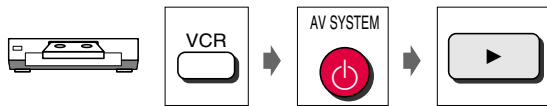

Switch on the player and start play

Switch off

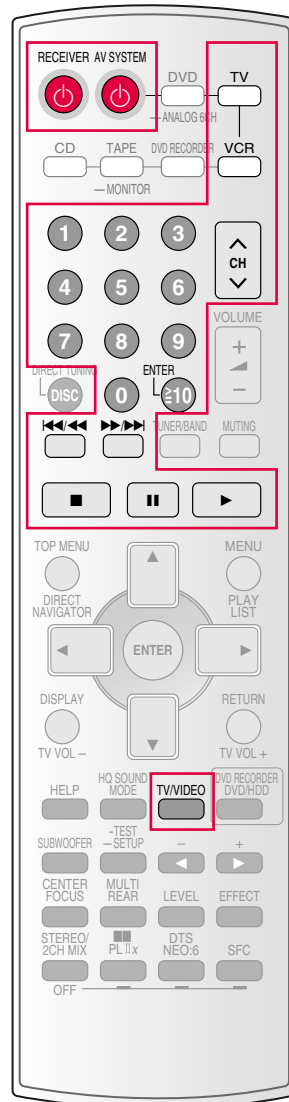
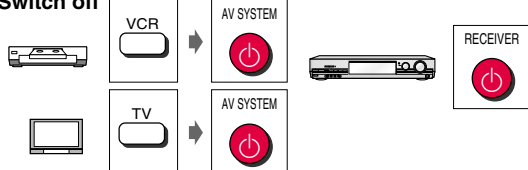

Operating the video deck



Rewind or fast-forward

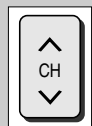

Change the channels sequentially

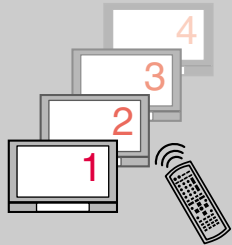

Select the channel directly



Stop play



Pause play

③ TV

Watching TV

Switch on



Switch on the television and select input

Switch off

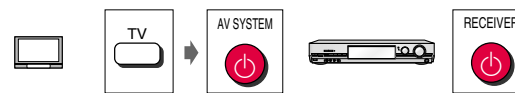

Operating the TV

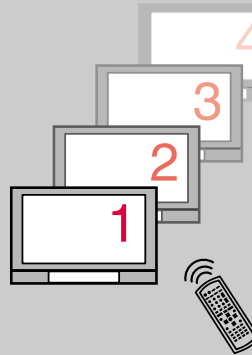

Change the channels sequentially

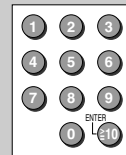

Select the channel directly

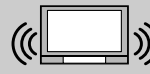

Adjust the volume

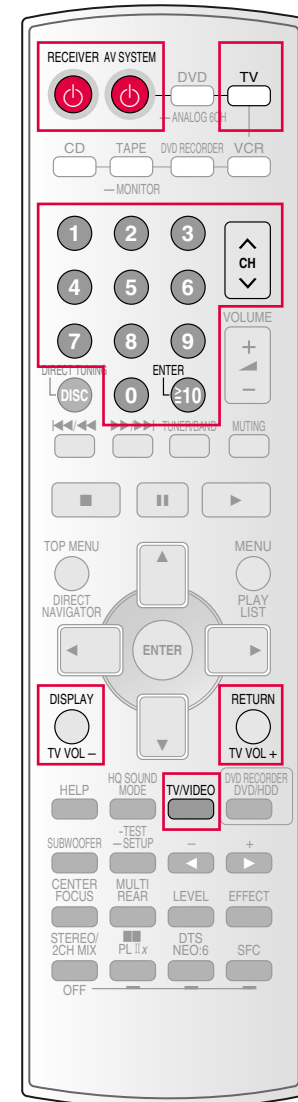

4 CD

Listening to CDs

Switch on

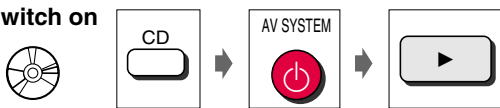

Switch on the player and start play

Switch off

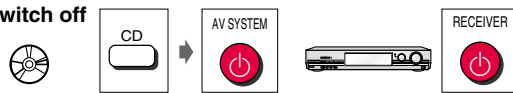

Operating the CD player

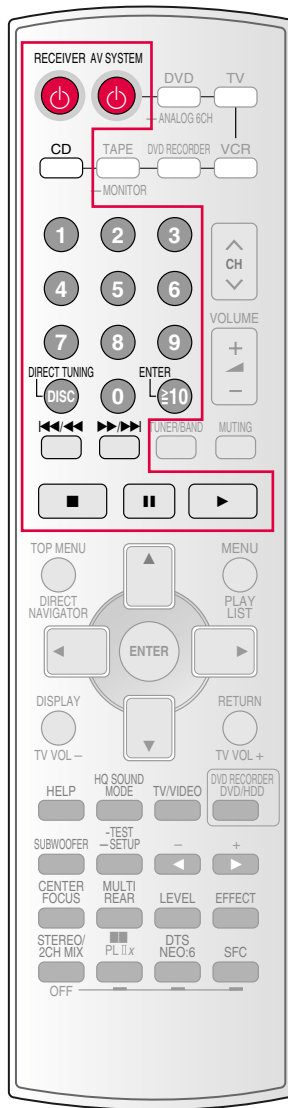
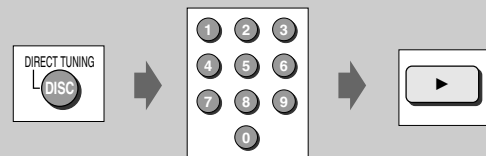
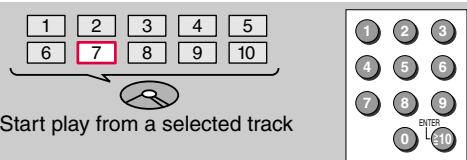

5 RADIO

Listening to the radio

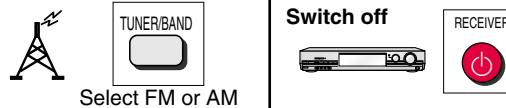

Operating the radio

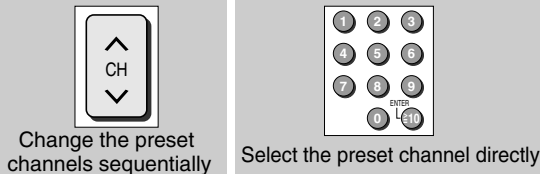

6 TAPE

Listening to tapes



Switch on the deck and start play

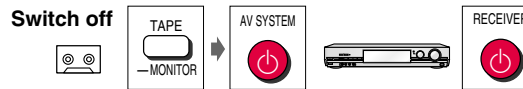

Operating the tape deck

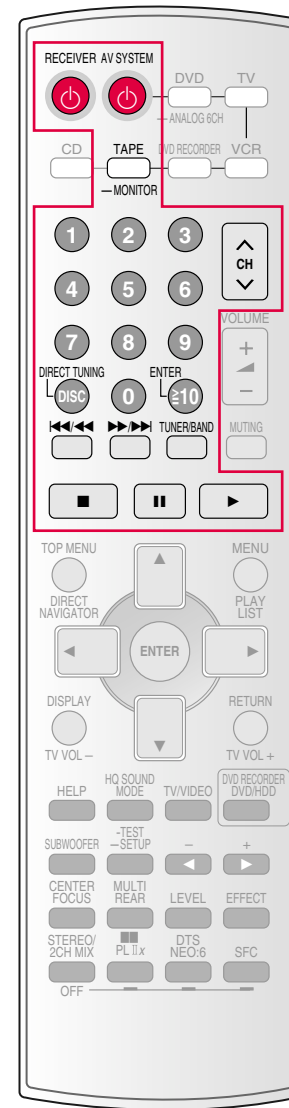

7 RECEIVER

DOLBY PRO LOGIC IIx MODE/DOLBY PRO LOGIC II MODE

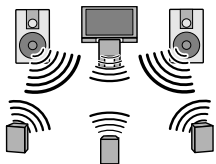

Select MOVIE (DOLBY EX), MUSIC or GAME when Dolby Pro Logic IIx mode or Dolby Pro Logic II mode is on



When you select MUSIC

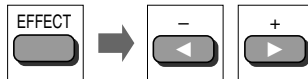

Change the sound effect

DTS NEO:6 MODE

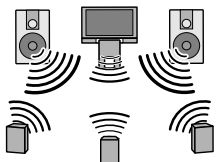

Select a DTS NEO:6 mode: CINEMA or MUSIC



When you select MUSIC

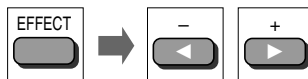

Change the sound effect

SFC MODE



Select MUSIC or AV/MOVIE

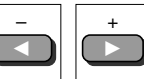

Select a mode

Select the speaker channel and adjust its output level

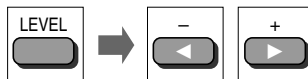

Change the sound effect

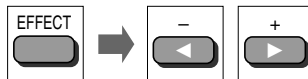

Adjusting speaker channel balance



Start a test signal

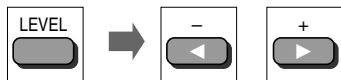

Select the speaker channel and adjust its output level



Stop the test signal

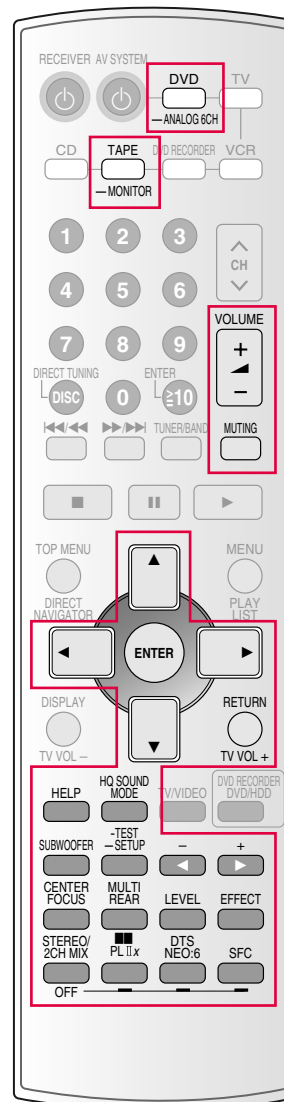

Other functions

To select STEREO or 2CH MIX mode
To cancel surround effect



To mute the volume



To adjust the volume



To select DVD ANALOG 6CH (Press and hold)



To start tape monitoring when recording to a 3 head cassette deck or using a graphic equalizer

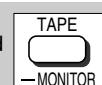

To display help messages To show the current remote control mode



To adjust subwoofer output level



To turn the center focus mode on



To turn the multi rear surround mode on



To turn the HQ sound mode on



To operate the On Screen Display menu (Press and hold)

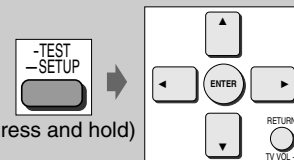

8 CODES

This remote control can operate Panasonic and Technics audio-visual equipment that has remote control sensors. You may need to change the remote control code. It can also operate some other brands of televisions, video cassette players, and DVD players. Check the table for the brand and enter the code as follows.

Changing the codes

TV VCR DVD player

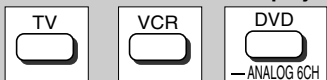

Press and hold the button corresponding to the equipment



Enter the first digit



Enter the second digit

The remote control outputs the on/off signal. If the code is correct, the equipment turns on or off. If it doesn't, try entering another code.

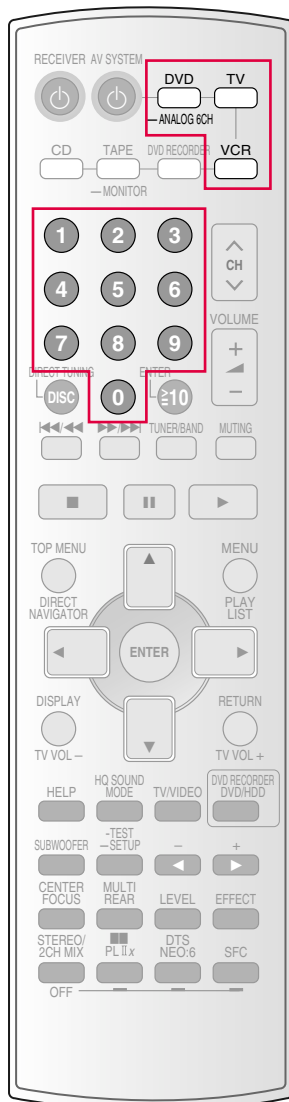

Code table

	TV	VCR	DVD player
Panasonic	01/02/26	01/02/09/33	01/40
Denon	—	—	01/17
Ferguson	—	—	02
Fisher	14	13/14/15/18 34	—
Funai	—	08/30	—
G.E.	02/03/07/09	02/03/11	—
GoldStar	07/15	27	—
Go-Video	—	—	12
Hitachi	05/07	09/10/11	11
JVC	12	19/25/31/38 39/40	09
Kenwood	—	—	15
LXI	03/06/07/10 14/15	10/13/14/15 18/27/30	—
Magnavox	06/07/11/15 22	02/09/12	—
Mitsubishi	07/15/16/21	21/22/28/29	06
NEC	07/15	19/25/31/38	—
Nordmende	—	—	02
Philco	06/07	02/09/12/30	—
Philips	06	02/09/12	04/16

	TV	VCR	DVD player
Pioneer	02/10/19	09	03
Polkaudio	—	—	16
Quasar	02	01/02/09/33	—
Raite	—	—	13
RCA	03/07/09/13 23/24/25	02/03/04/09 10/11/12/23 24/26	02
Saba	—	—	02
Sampo	—	—	14
Samsung	—	—	10
Sanyo	14	14/18/34	—
Sharp	08/21	16/17	08
Shintom	—	32	—
Sony	04	05/06/07/35 36/37	05
Sylvania	06/07/15	02/09/12/30	—
Symphonic	17	30	—
Technics	—	—	01
Thomson	—	—	02
Toshiba	10/21	23/24	04
Yamaha	—	—	01
Zenith	18/20	20	07/12

- Note that this remote control cannot operate some equipment and that it may not be able to perform some operations.
- Re-enter the codes after you change the batteries.